

# SIMPLYFRIDGE



Team : BitBuilder

Team Members : Edward Li, Xinshuo Zhou, and Emily Yin



# OVERVIEW

- **App Name:** SimplyFridge
- **App Description:** The app has three main functions: tracking the expiration dates of items in your fridge or pantry, operating as a shopping list, and using the items on the expiration list to generate recipe ideas.
- **Track:** Youth Team
- **Category:** Climate & sustainability



# THEME

Globally, 40% of the food produced each year—approximately 1.3 billion tons—gets lost or wasted. That's more than enough food to take care of the 821 million people who suffer from hunger worldwide. Food waste squanders the water, energy, land, and labor that went into producing and transporting those ingredients—and it's a huge contributor to climate change, too.



# THEME

As it rots in a landfill, food produces methane, a greenhouse gas that's 25 times more potent than carbon dioxide. That means our collective food waste generates about 10 percent of global emissions. Some people don't care about the hungry or climate control, but it is beneficial to you as well. If you don't waste food, you can save tens of thousands of dollars every year! In result, the theme of our project is Climate and Sustainability!



# INSTRUCTIONS

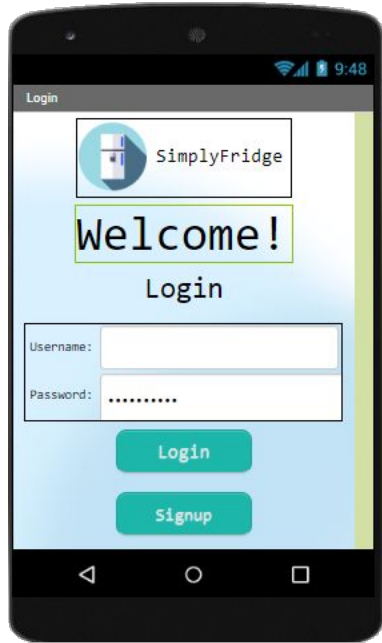

Step 1: The screen initializes on the login, from here you can login or go to the signup page

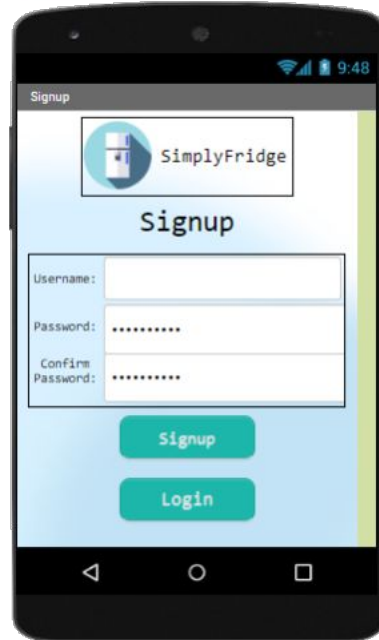

Step 2: If you do not have an account, you can sign up, or if you mistakenly clicked signup, you can go back to login

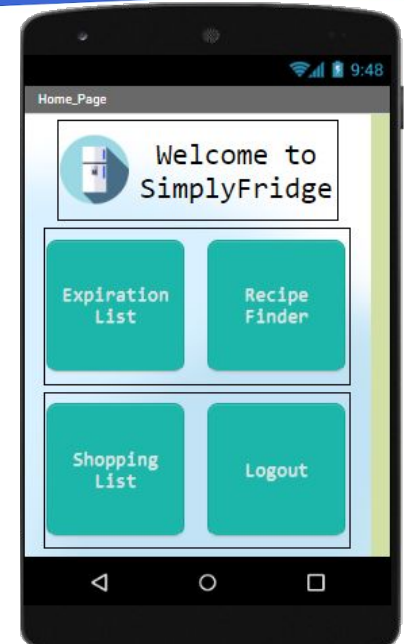

Step 3: After logging in or signing up, you will enter the home screen, where you can access all other pages in the app and logout



# INSTRUCTIONS

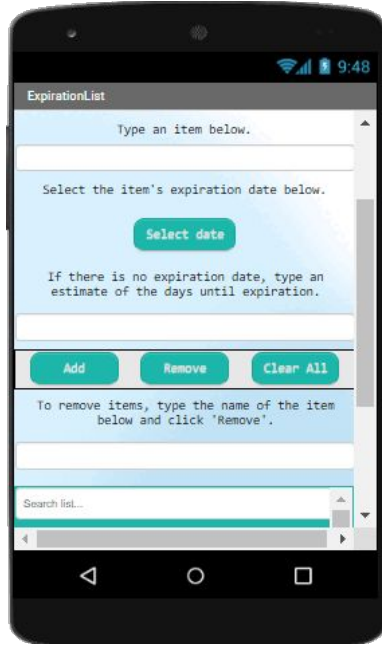

Step 4: You can add items with their expiration dates and also remove them. You can also sort them.



Step 5: In recipe finder, you can generate Chat GPT made recipes out of the ingredients you have

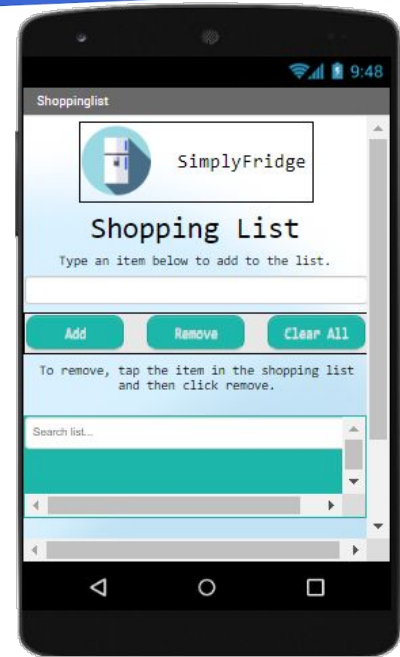

Step 6: A convenient shopping list for adding ingredients during the storage process where the app is meant to be used



# LIMITATIONS

- Some limitations on this project is that the is dependable on Chat GPT so the dishes might be not good or it will not work after a lot of refreshes.
- A minimum of five items are required in the expiration list to use the recipe finder.



# ACKNOWLEDGEMENTS

- Our Parents: They gave motivation, resources, and helped us think of ideas
- Dr. Yu Meng: He helped us by giving experience and tell us the flaws of our project.





# APPENDIX

## FLOW CHART:

